

ATTENZIONE - ATTENTION - ACHTUNG

- Per lo smontaggio degli utensili utilizzare sempre la chiave di contrasto come indicato nel manuale d'uso.
- For disassembly of the tools use always the contrast key as mentioned in the user instructions.
- Fuer das Abmontieren der Werkzeuge immer den Gegenschlüssel benutzen wie in der Bedienungsanleitung erwaeht.

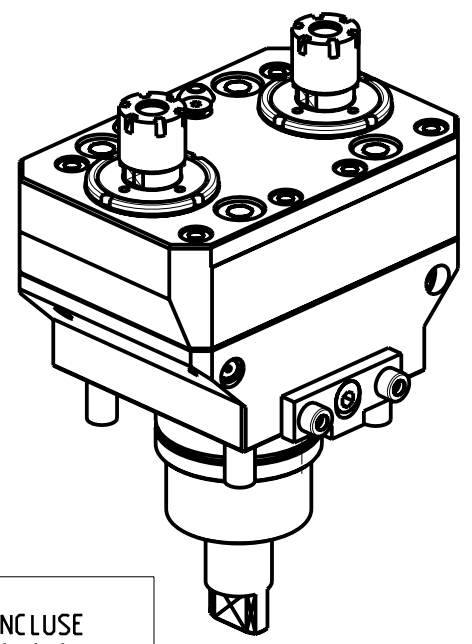

Cod. MT	Cod. BIGLIA	Mandrino Spindle Spindel	I	RPM	Reversibile lato mandrino/contromandrino Reversible sub/main spindle side Umkehrbare Spindel-seite/ Gegenspindel-seite	Lubrificazione int. Coolant through Innenkuehlung	Lubrificazione est. Ext. coolant Aussenkuehlung	CHIAVI NON INCLUSE Keys not included Schluesel nicht einbegriffen		
BGL0030216	-	ER16	1:2	8000	X		X	CHMNER16	CHUB17	NEW

BIGLIA
 MOD: B301/445/470/501(Y-S)/510/545/550/565/650/658/1200
 MODULO MOTORIZZATO RADIALE 2 USCITE SOVRAPPOSTE I=1:2
 Radial single side twin head driven tool I=1:2
 Radial angetriebenes Werkzeug 2 Ausgaenge ueberlagert I=1:2

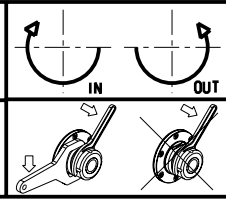

M.T. srl
 Via dei Tamerici 1/3
 Tel. 0541/956034-957884
 Fax 0541/956341
 47842 S. GIOVANNI IN M. (RN)
 e-mail: mtma@mtmarchetti.com
 http://www.mtmarchetti.com

PRODUZIONE MODULI ROTANTI

PAGINA BGL080-1-10