

Cod. MT	Mandrino Spindle Spindel	I	RPM	Lubrificazione int. Coolant through Innenkuehlung	Lubrificazione est. Ext. coolant Aussenkuehlung	ØD	L	A1	A2	A3	B	CHIAVI NON INCLUSE Keys not included Schluessel nicht einbegriffen	
SAU0070125	ER25	1:1	6000		X			80.66			45	CHUB36	CHSTER25
SAU0071125	ER25	1:1	6000	P=70bar	X			94.66			59	CHUB36	CHSTER25
SAU0070225	ERA25	1:1	6000		X			70.03			45	CHUB40	CHUB27
SAU0071225	ERA25	1:1	6000	P=70bar	X			84.03			59	CHUB40	CHUB27
SAU0070316	WELDON16	1:1	6000		X					66.5	45	-	-
SAU0071316	WELDON16	1:1	6000	P=70bar	X					80	59	-	-
SAU0070416	Ø16x17	1:1	6000		X	16	17		59.5		45	CHUB36	CH_VTCROCE_M08 *
SAU0070422	Ø22x19	1:1	6000		X	22	19		61.5		45	CHUB36	CH_VTCROCE_M10 *

NEW
NEW
NEW
NEW
NEW
NEW
NEW
NEW

- Chiave inclusa
- Key included
- Schluessel inbegriffen

SAUTER
VDI 30

MODULO MOTORIZZATO ASSIALE VDI30 DIN 5480
Axial driven tool VDI30 DIN 5480
Axial angetriebenes Werkzeug VDI30 DIN 5480

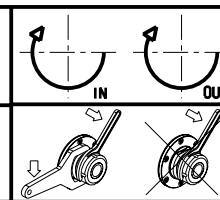

M.T. srl
Via dei Tamerici 1/3
Tel. 0541/956034-957884
Fax 0541/956341
47842 S. GIOVANNI IN M. (RN)
e-mail: mima@mlmarchetti.com
http://www.mlmarchetti.com

PRODUZIONE MODULI ROTANTI



PAGINA SAU017-1-00